

Annie's  
Attic®

CROCHET

easy SIDE-to-SIDE  
**JACKETS**  
& **SHRUGS**™

Designs by TAMMY HILDEBRAND

Turn heads  
with these stylish,  
attention-getting  
crochet designs.



4  
Easy-to-make  
Projects!

C R O C H E T

# Easy Side-to-Side Jackets & Shrugs™

*Designs by Tammy Hildebrand*

## General Information

Many of the products used in this pattern book can be purchased from local craft, fabric and variety stores, or from the Annie's Attic Needlecraft Catalog (see *Customer Service information on page 12*).

## Contents

Carnaby Street Jacket..... 2

Via Condotti Jacket ..... 4

Madison Avenue Shrug..... 6

Avenue Montaigne Shrug ..... 8

Stitch Guide..... 11





# Carnaby Street Jacket

## SKILL LEVEL



EASY

## FINISHED SIZES

Instructions given fit 30–32-inch bust (*small*); changes for 34–36-inch bust (*medium*), 38–40-inch bust (*large*) and 42–44-inch bust (*X-large*) are in [ ].

## FINISHED MEASUREMENTS

Bust: 36 inches (*small*) [39¾ inches (*medium*), 43½ inches (*large*), 47¼ inches (*X-large*)]

## MATERIALS

- Lion Brand Microspun light (light worsted) weight yarn (2½ oz/ 168 yds/70g per skein): 6 [8, 10, 12] skeins #186 mango
- Size I/9/5.5mm crochet hook or size needed to obtain gauge
- Tapestry needle



## GAUGE

14 sc = 4 inches; 10 pattern rows = 4 inches

## SPECIAL STITCH

**Cross-stitch (cross-st):** Sk next st, dc in next st, working over last st made, dc in sk st.

## INSTRUCTIONS

### JACKET

**Row 1 (RS):** Starting at cuff of sleeve, ch 53, sc in 2nd ch from hook and in each ch across, turn. (52 sc)

**Row 2:** Ch 3 (*counts as first dc*), **cross-st** (*see Special Stitch*) across to last st, dc in last st, turn. (25 cross-sts, 2 dc)

**Row 3:** Ch 1, sc in each st across, turn. (52 sc)

**Rows 4–44 [4–44, 4–46, 4–46]:** Rep rows 2 and 3 alternately, ending with row 2.

**Row 45 [45, 47, 47]:** For **right front**, ch 35 [37, 39, 41], drop lp from hook, join separate skein with sl st in last st, for **back**, ch 34 [36, 38, 40]. Fasten off. Pick up dropped lp, sc in 2nd ch from hook and in each ch across front, sc in each st across sleeve, and sc in each ch across back, turn. (120 [124, 128, 132] sc)

**Rows 46–63 [46–65, 48–69, 48–71]:** Rep rows 2 and 3 alternately.

**Row 64 [66, 70, 72]:** Ch 3, cross-st 29 [30, 31, 32] times, dc in next st, leaving rem sts unworked, turn. (29 [30, 31, 32] cross-sts, 2 dc)

**Row 65 [67, 71, 73]:** Ch 1, sc in each st across, turn. (60 [62, 64, 66] sc)

**Rows 66–70 [68–74, 72–80, 74–84]:** Rep rows 2 and 3 alternately.

**Row 71 [75, 81, 85]:** For **left front**, ch 61 [63, 65, 67], sc in 2nd ch from hook and in each ch and st across, turn. (120 [124, 128, 132] sc)

**Rows 72–89 [76–95, 82–103, 86–111]:** Rep rows 2 and 3 alternately. Fasten off at end of last row.

**Row 90 [96, 104, 112]:** Sk first 34 [36, 38, 40] sts, join with sl st in next st, ch 3, cross-st 25 times, dc in next st, leaving rem sts unworked, turn. (25 cross-sts, 2 dc)

**Row 91 [97, 105, 113]:** Ch 1, sc in each st across, turn. (52 sc)

**Rows 92–135 [98–141, 106–151, 114–159]:** Rep rows 2 and 3 alternately. Fasten off at end of last row. Sew sleeve and side seams.

### BOTTOM EDGING

**Row 1:** With WS facing, working in ends of rows along bottom edge, join with sc in first row, evenly sp 126 [144 162, 180] sc across bottom edge, turn. (127 [145, 163, 181] sc)

**Row 2:** Ch 1, sc in first st, [sk next st, dc in next st, ch 3, working over last st made, dc in sk st, sc in next st] across. Fasten off.

### SLEEVE EDGING

Join with sl st in any st on 1 sleeve, ch 6 (*counts as first dc and ch-3 sp*), working over ch-6, dc in previous st, [sk next st, dc in next st, ch 3, working over last st made, dc in sk st] around, join with sl st in 3rd ch of beg ch-6. Fasten off.

Rep on other Sleeve. □□

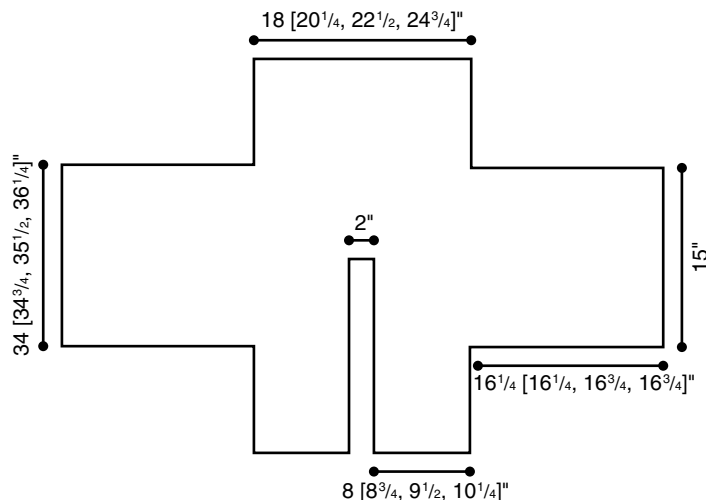



# Via Condotti Jacket

## SKILL LEVEL



EASY

## FINISHED SIZES

Instructions given fit 34-inch bust (*small*); changes for 36-inch bust (*medium*), 38-inch bust (*large*) and 40-inch bust (*X-large*) are in [ ].

## FINISHED MEASUREMENTS

Bust: 37 inches (*small*) [40 inches (*medium*), 43 inches (*large*), 46 inches (*X-large*)]

## MATERIALS

- Red Heart LusterSheen fine (sport) weight yarn (4 oz/335 yds/113g per skein):  
3 [4, 5, 5] skeins  
#0805 natural



- Size G/6/4mm crochet hook or size needed to obtain gauge
- Tapestry needle

## GAUGE

17 dc = 4 inches; 4 dc rows and 3 tr rows = 4 inches

## INSTRUCTIONS

### JACKET

**Row 1 (RS):** Starting at cuff of sleeve, ch 71, dc in 4th ch from hook and in each ch across, turn. (69 dc)

**Row 2:** Ch 5 (*counts as first tr and ch-1 sp*), sk next st, tr in next st, [ch 1, sk next st, tr in next st] across, turn. (35 tr, 34 ch sps)

**Row 3:** Ch 3 (*counts as first dc*), dc in each ch sp and in each st across, turn. (69 dc)

**Rows 4–28 [4–28, 4–30, 4–30]:** Rep rows 2 and 3 alternately, ending with row 2.

**Row 29 [29, 31, 31]:** For **right front**, ch 70, drop lp from hook, join separate skein with sl st in last st, for **back**, ch 68. Fasten off. Pick up dropped lp, dc in 4th ch from hook and in each ch across for front, dc in each st across sleeve and dc in each ch across for back, turn. (205 dc)

**Rows 30–41 [30–43, 32–47, 32–49]:** Rep rows 2 and 3 alternately.

**Row 42 [44, 48, 50]:** Ch 5, sk next st, tr in next st, [ch 1, sk next st, tr in next st] 47 times, leaving rem sts unworked, turn. (49 tr, 48 ch sps)

**Row 43 [45, 49, 51]:** Ch 3, dc in each ch sp and st across, turn. (97 dc)

**Rows 44–48 [46–50, 50–54, 52–56]:** Rep rows 2 and 3 alternately, ending with row 2.

**Row 49 [51, 55, 57]:** For **left front**, ch 110, dc in 4th ch from hook and in each ch, st and ch sp across, turn. (205 dc)

**Rows 50–61 [52–65, 56–71, 58–75]:** Rep rows 2 and 3 alternately. Fasten off at end of last row.

**Row 62 [66, 72, 76]:** For **2nd sleeve**, sk first 68 sts, join with sl st in next st, ch 5, sk next st, tr in next st, [ch 1, sk next st, tr in next st] 33 times, turn, leaving rem sts unworked, turn. (35 tr, 34 ch sps)

**Row 63 [67, 73, 77]:** Ch 3, dc in each ch sp and st across, turn. (69 dc)

**Rows 64–89 [68–93, 74–101, 78–105]:** Rep rows 2 and 3 alternately. Fasten off at end of last row.

Sew sleeve and side seams. □□

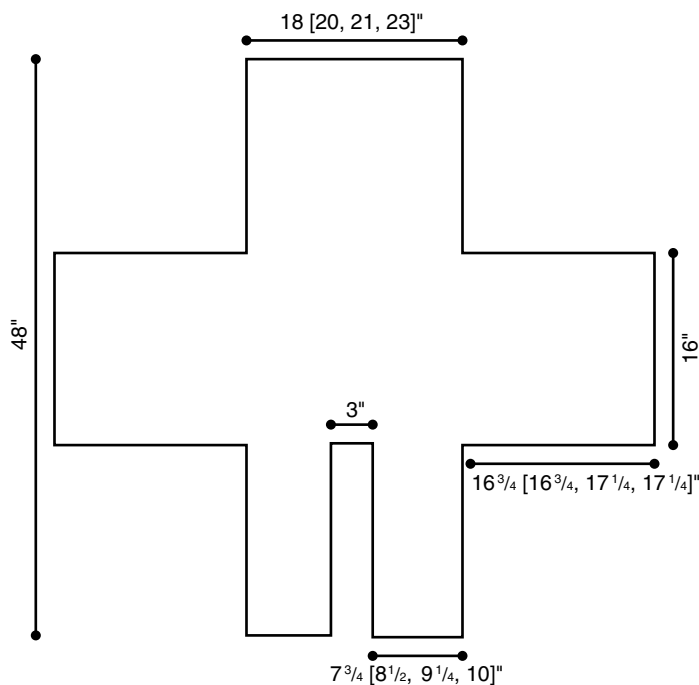





# Madison Avenue Shrug

## SKILL LEVEL



EASY

## FINISHED SIZES

Instructions given fit 30–32-inch bust (*small*); changes for 34–36-inch bust (*medium*), 38–40-inch bust (*large*) and 42–44-inch bust (*X-large*) are in [ ].

## FINISHED MEASUREMENTS

Bust: 36 inches (*small*) [39 inches (*medium*), 41½ inches (*large*), 45 inches (*X-large*)]

## MATERIALS

- Aunt Lydia's Madison Avenue light (light worsted) weight yarn  (1¾ oz/73 yds/50g per skein):  
10 [13, 16, 19] skeins  
#488 midnight
- Size J/10/6mm crochet hook or size needed to obtain gauge
- Tapestry needle
- Sewing needle
- ¾-inch button
- Matching sewing thread

## GAUGE

13 sc = 4 inches; 12 pattern rows = 4 inches

## INSTRUCTIONS

### JACKET

**Row 1 (RS):** Starting at cuff of sleeve, ch 51, sc in 2nd ch from hook and in each ch across, turn. (50 sc)

**Row 2:** Ch 2 (*counts as first hdc*), hdc in each st across, turn. (50 hdc)

**Row 3:** Ch 1, sc in each st across, turn. (50 sc)

**Rows 4–52 [4–52, 4–54, 4–54]:** Rep rows 2 and 3 alternately, ending with row 2.

**Row 53 [53, 55, 55]:** For **right front**, ch 27 [28, 29, 30], drop lp from hook, join separate skein with sl st in last st, for **back**, ch 26 [27, 28, 29]. Fasten off. Pick up dropped lp, sc in 2nd ch from hook and in each ch across for front, sc in each st across sleeve and sc in each ch across for back, turn. (102 [104, 106, 108] sc)

**Row 54 [54, 56, 56]:** Ch 2, hdc in each st across, turn. (102 [104, 106, 108] hdc)

**Row 55 [55, 57, 57]:** Ch 1, sk first st, sc in each st across, turn. (101 [103, 105, 107] sc)

**Row 56 [56, 58, 58]:** Ch 2, hdc in each st across, leaving last st unworked, turn. (100 [102, 104, 106] sc)

**Rows 57–77 [57–79, 59–83, 59–85]:** Rep rows 55 and 56 [55 and 56, 57 and 58, 57 and 58] alternately, ending with row 55 [55, 57, 57]. (79 [79, 79, 79] sc at end of last row)

**Row 78 [80, 84, 86]:** Ch 2, hdc in each of next 50 [51, 52, 53] sts, leaving rem sts unworked, turn. (51 [52, 53, 54] hdc)

**Row 79 [81, 85, 87]:** Ch 1, sc in each st across, turn. (51 [52, 53, 54] sc)

**Row 80 [82, 86, 88]:** Ch 2, hdc in each st across, turn. (51 [52, 53, 54] hdc)

**Rows 81–84 [83–86, 87–90, 89–92]:** Rep rows 79 and 80 [81 and 82, 85 and 86, 87 and 88] alternately.

**Row 85 [87, 91, 93]:** For **left front**, ch 29 [28, 27, 26], sc in 2nd ch from hook and in each ch and st across, turn. (79 [79, 79, 79] sc)

**Row 86 [88, 92, 94]:** Ch 2, hdc in each st across to last st, 2 hdc in last st, turn. (80 [80, 80, 80] hdc)

**Row 87 [89, 93, 95]:** Ch 1, 2 sc in first st, sc in each st across, turn. (81 [81, 81, 81] sc)

**Rows 88–108 [90–112, 94–118, 96–122]:** Rep rows 86 and 87 [88 and 89, 92 and 93, 94 and 95]

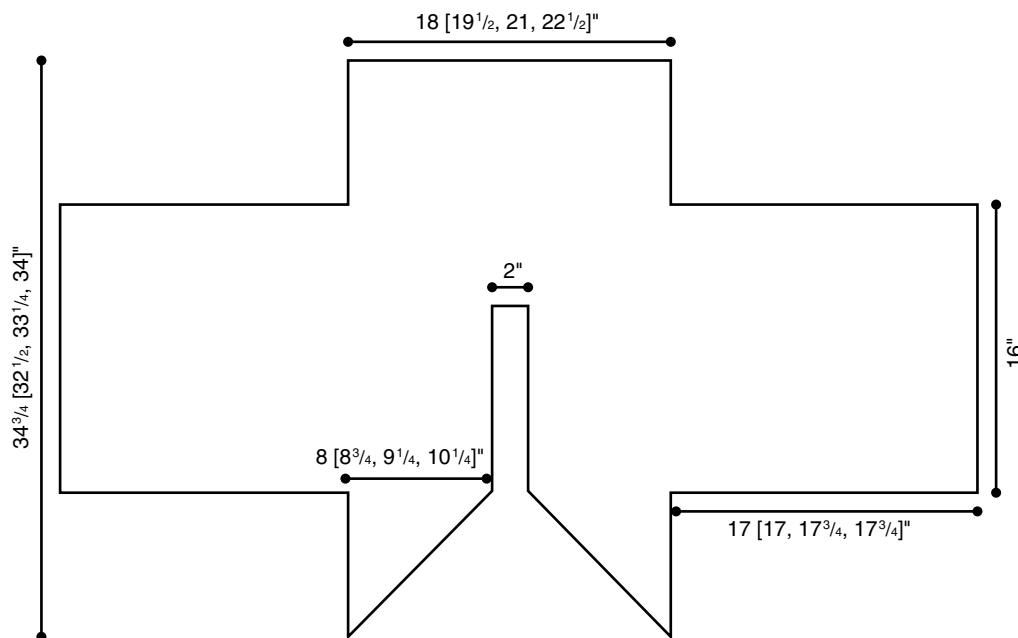







alternately, ending with row 86 [88, 92, 94]. (102 [104, 106, 108] hdc at end of last row)

**Row 109 [113, 119, 123]:** Ch 1, sc in each st across, turn. (102 [104, 106, 108] sc)

**Row 110 [114, 120, 124]:** Ch 2, hdc in each st across, turn. (102 [104, 106, 108] hdc)

**Row 111 [115, 121, 125]:** Ch 1, sc in each st across, turn. Fasten off. (102 [104, 106, 108] sc)

**Row 112 [116, 122, 126]:** For

**2nd sleeve,** sk first 26 [27, 28, 29] sts on last row, join with sl st in next st, ch 2, hdc in each of next 49 sts, leaving rem sts unworked, turn. (50 hdc)

**Row 113 [117, 123, 127]:** Ch 1, sc in each st across turn. (50 sc)

**Row 114 [118, 124, 128]:** Ch 2, hdc in each st across, turn. (50 hdc)

**Rows 115–163 [119–167, 125–175, 129–179]:** Rep rows 113 and 114 [117 and 118, 123 and 124, 127 and 128] alternately, ending with

row 113 [117, 123, 127]. Fasten off at end of last row.

Sew sleeve and side seams.

### EDGING

Join with sc in bottom right-hand corner; evenly sp sts so piece lies flat, sc around entire outer edge, join with sl st in beg sc. Fasten off. With sewing needle and sewing thread, sew button to top right front using sps between sts on left front for buttonhole. □□

## Avenue Montaigne Shrug

### SKILL LEVEL



EASY

### FINISHED SIZES

Instructions given fit 30–32-inch bust (*small*); changes for 34–36-inch bust (*medium*), 38–40-inch bust (*large*) and 42–44-inch bust (*X-large*) are in [ ].

### FINISHED MEASUREMENTS

Bust: 35½ inches (*small*) [39½ inches (*medium*), 43½ inches (*large*), 47½ inches (*X-large*)]

### MATERIALS

- Aunt Lydia's Twinkles light (light worsted) weight yarn (1¾ oz/93 yds/50g per skein): 8 [10, 12, 14] skeins #258 purple
- Size 1/9/5.5mm crochet hook or size needed to obtain gauge
- Tapestry needle
- Sewing needle
- 1-inch button
- Matching sewing thread



### GAUGE

13 sc = 4 inches; 5 sc rows and 4 dc rows = 4¼ inches

### INSTRUCTIONS

#### SHRUG

**Row 1 (RS):** Starting at cuff of sleeve, ch 52, sc in 2nd ch from hook and in each ch across, turn. (51 sc)

**Row 2:** Ch 4 (*counts as first dc and ch-1 sp*), sk next st, [dc in each of next 2 sts, ch 1, sk next st] across to last st, dc in last st, turn. (34 dc, 17 ch sps)

**Row 3:** Ch 1, sc in each st and in each sp across, turn. (51 sc)

**Rows 4–35:** Rep rows 2 and 3 alternately.

**Row 36:** For **right front**, ch 21 [24, 27, 30], drop lp from hook, join separate skein with sl st in last st, for **back**, ch 19 [22, 25, 28]. Fasten off. Pick up dropped lp, dc in 4th ch from hook, [ch 1, sk next ch, dc in each of next 2 chs] 5 [6, 7, 8] times for front, ch 1, sk next ch, dc in next ch, dc in next st, [ch 1, sk next st, dc in each of next 2 sts] 16 times across sleeve, ch 1, sk next st, dc in next st, dc in next ch, [ch 1, sk next ch, dc in each of next 2 chs] 6 [7, 8, 9] times for back, turn. (60 [64, 68, 72] dc, 29 [31, 33, 35] ch sps)

**Row 37:** Ch 1, sc in each st and ch sp across, turn. (89 [95, 101, 107] sc)

**Row 38:** Ch 3 (*counts as first dc*), dc in next st, [ch 1, sk next st, dc in each of next 2 sts] across to last 3 sts, ch 1, sk next st, dc in next st, leaving last st unworked, turn. (59 [63, 67, 71] dc, 29 [31, 33, 35] ch sps)

**Row 39:** Sl st in next ch sp, ch 1, sc in same sp, sc in each st and in each ch sp across, turn. (87 [93, 99, 105] sc)

**Row 40:** Ch 3, dc in next st, [ch 1, sk next st, dc in each of next 2 sts] across to last 4 sts, ch 1, sk next

st, dc in next st, leaving last 2 sts unworked, turn. (57 [61, 65, 69] dc, 28 [30, 32, 34] ch sps)

**Rows 41–49 [41–51, 41–53, 41–55]:** Rep rows 39 and 40 alternately, ending with row 39. (72 [75, 78, 81] sc)

**Row 50 [52, 54, 56]:** Ch 3, dc in next st, [ch 1, sk next st, dc in each of next 2 sts] 14 [15, 16, 17] times, leaving rem sts unworked, turn. (30 [32, 34, 36] dc, 14 [15, 16, 17] ch sps)

**Row 51 [53, 55, 57]:** Ch 1, sc in each st and ch sp across, turn. (44 [47, 50, 53] sc)

**Row 52 [54, 56, 58]:** Ch 3, dc in next st, [ch 1, sk next st, dc in each of next 2 sts] across, turn. (30 [32, 34, 36] dc, 14 [15, 16, 17] ch sps)

**Rows 53–56 [55–58, 57–60, 59–62]:** Rep rows 51 and 52 [53 and 54, 55 and 56, 57 and 58] alternately.

**Row 57 [59, 61, 63]:** For **left front**, ch 29, sc in 2nd ch from hook and in each ch and st across, turn. (72 [75, 78, 81] sc)

**Row 58, [60, 62, 64]:** Ch 3, dc in next st, [ch 1, sk next st, dc in each of next 2 sts] across to last 4 sts, ch 1, sk next st, 2 dc in next st, ch 1, sk next st, dc in next st, turn. (49 [51, 53, 55] dc, 24 [25, 26, 27] ch sps)

**Row 59 [61, 63, 65]:** Ch 3, sc in 2nd ch from hook, sc in each ch and st across, turn. (75 [78, 81, 84] sc)

**Rows 60–67 [62–71, 64–75, 66–79]:** Rep rows 58 and 59 [60 and 61, 62 and 63, 64 and 65] alternately. (87 [93, 99, 105] sc at end of last row)





**Row 68 [72, 76, 80]:** Rep row 58 [60, 62, 64, 71]. (59 [63, 67, 71] dc, 29 [31, 33, 35] ch sps)

**Row 69 [73, 77, 81]:** Ch 2, sc in 2nd ch from hook and in each st and ch across, turn. (89 [95, 101, 107] sc)

**Row 70 [74, 78, 82]:** Ch 3, dc in next st, [ch 1, sk next st, dc in each of next 2 sts] across, turn. Fasten off. (60 [64, 68, 72] dc, 29 [31, 33, 35] ch sps)

**Row 71 [75, 79, 83]:** For **2nd sleeve**, Sk first 19 [22, 25, 28] sts and chs on last row, join with sc in next st, [sc in next ch sp, sc in each of next 2 sts] 16 times, sc in next ch sp, sc

in next st, leaving rem sts unworked, turn. (51 sc)

**Rows 72–105 [76–109, 80–113, 84–117]:** Rep rows 2–35 of first sleeve.

Fasten off at end of last row.

Sew sleeve and side seams

**EDGING**

Join with sc in bottom right-hand corner; evenly sp sts so piece lies flat, sc around entire outer edge, join with sl st in beg sc. Fasten off.

**COLLAR**

**Row 1:** Working on 65 sts across neck edge, join with sc in first st, sc in each

of next 5 sts, 2 dc in each of next 21 sts, dc in each of next 11 sts, 2 dc in each of next 21 sts, sc in each of next 6 sts, turn. (107 sc)

**Row 2:** Ch 1, sc in each of first 6 sts, hdc in each of next 21 sts, dc in each of next 53 sts, hdc in each of next 21 sts, sc in each of last 6 sts. Fasten off.

Fold Collar back and tack in place on each side.

For buttonhole, join with sl st at top left front below Collar, ch 6, sl st in same st. Fasten off.

With sewing needle, sew button to top right front opposite buttonhole. □□

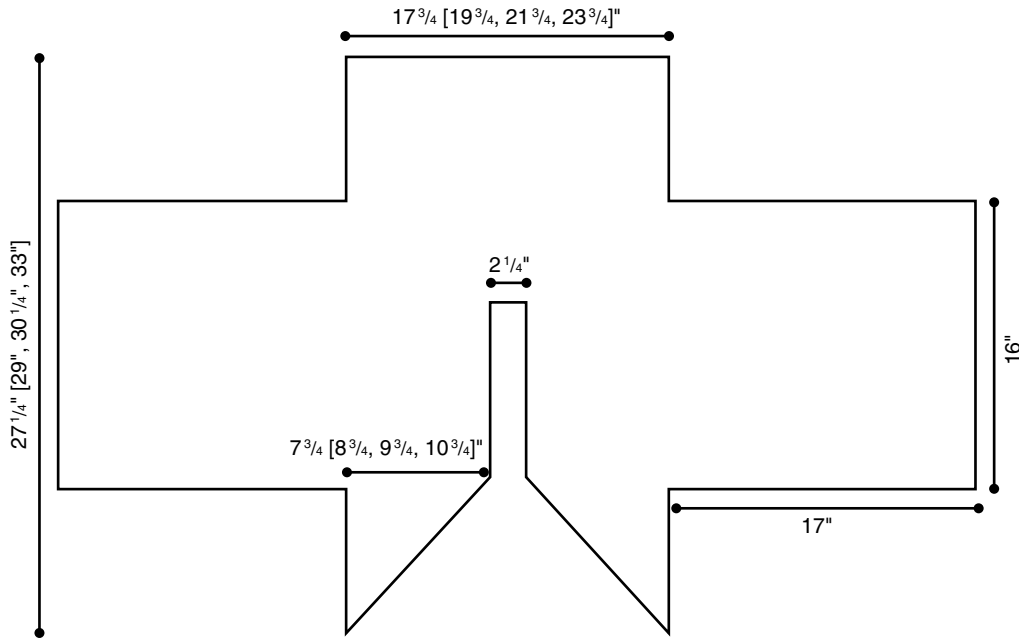

# Stitch Guide

## ABBREVIATIONS

**beg** .....begin/beginning  
**bpdc** .....back post double crochet  
**bpsc** ..... back post single crochet  
**bp tr** .....back post treble crochet  
**CC** .....contrasting color  
**ch** .....chain stitch  
**ch-** .....refers to chain or space previously made (i.e., ch-1 space)  
**ch sp** .....chain space  
**cl** .....cluster  
**cm** .....centimeter(s)  
**dc** .....double crochet  
**dec.** .....decrease/decreases/decreasing  
**dtr** .....double treble crochet  
**fpdc** .....front post double crochet  
**fp sc** .....front post single crochet  
**fp tr** .....front post treble crochet  
**g** .....gram(s)  
**hdc** .....half double crochet  
**inc** .....increase/increases/increasing  
**lp(s)** .....loop(s)  
**MC** .....main color  
**mm** .....millimeter(s)  
**oz** .....ounce(s)  
**pc** .....popcorn  
**rem** .....remain/remaining  
**rep** .....repeat(s)  
**rnd(s)** .....round(s)  
**RS** .....right side  
**sc** .....single crochet  
**sk** .....skip(ped)  
**sl st** .....slip stitch  
**sp(s)** .....space(s)  
**st(s)** .....stitch(es)  
**tog** .....together  
**tr** .....treble crochet  
**trtr** .....triple treble  
**WS** .....wrong side  
**yd(s)** .....yard(s)  
**yo** .....yarn over

**Chain—ch:** Yo, pull through lp on hook.

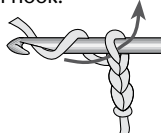

**Slip stitch—sl st:** Insert hook in st, yo, pull through both lps on hook.



**Single crochet—sc:** Insert hook in st, yo, pull through st, yo, pull through both lps on hook.

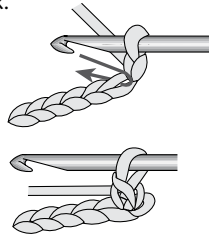

**Front loop—front lp**  
**Back loop—back lp**

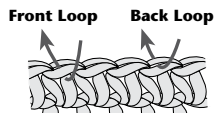

**Front post stitch—fp:**  
**Back post stitch—bp:** When working post st, insert hook from right to left around post st on previous row.

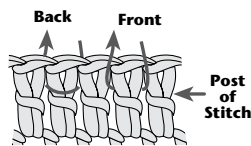

**Half double crochet—hdc:** Yo, insert hook in st, yo, pull through st, yo, pull through all 3 lps on hook.

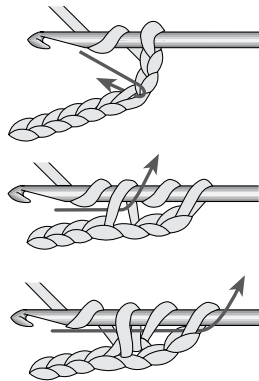

**Double crochet—dc:** Yo, insert hook in st, yo, pull through st, [yo, pull through 2 lps] twice.

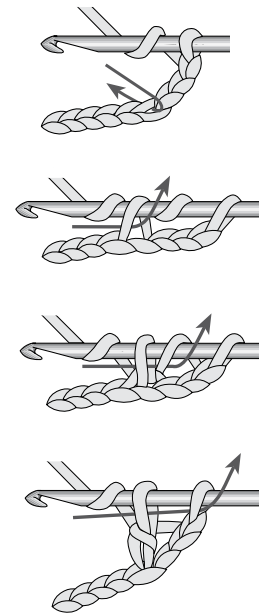

**Change colors:** Drop first color; with 2nd color, pull through last 2 lps of st.

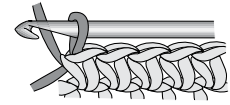

**Treble crochet—tr:** Yo 2 times, insert hook in st, yo, pull through st, [yo, pull through 2 lps] 3 times.

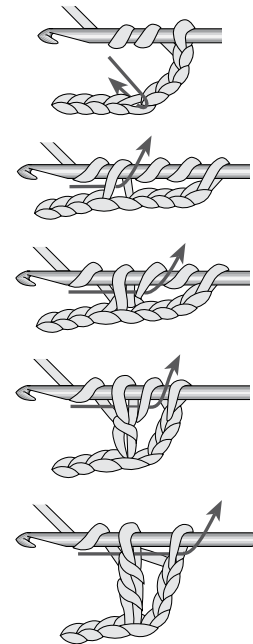

**Double treble crochet—dtr:** Yo 3 times, insert hook in st, yo, pull through st, [yo, pull through 2 lps] 4 times.

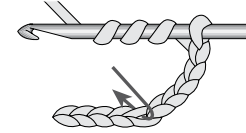

**Single crochet decrease (sc dec):** (Insert hook, yo, draw up a lp) in each of the sts indicated, yo, draw through all lps on hook.

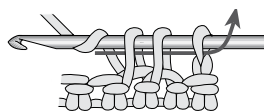

Example of 2-sc dec

**Half double crochet decrease (hdc dec):** (Yo, insert hook, yo, draw lp through) in each of the sts indicated, yo, draw through all lps on hook.

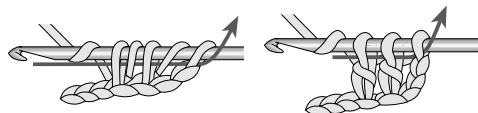

Example of 2-hdc dec

**Double crochet decrease (dc dec):** (Yo, insert hook, yo, draw lp through, yo, draw through 2 lps on hook) in each of the sts indicated, yo, draw through all lps on hook.



Example of 2-dc dec

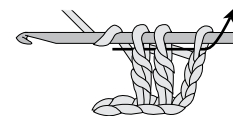

Example of 2-tr dec

**Treble crochet decrease (tr dec):** Holding back last lp of each st, tr in each of the sts indicated, yo, pull through all lps on hook.

### US

sl st (slip stitch)  
 sc (single crochet)  
 hdc (half double crochet)  
 dc (double crochet)  
 tr (treble crochet)  
 dtr (double treble crochet)  
 skip

### UK

= sc (single crochet)  
 = dc (double crochet)  
 = htr (half treble crochet)  
 = tr (treble crochet)  
 = dtr (double treble crochet)  
 = ttr (triple treble crochet)  
 = miss

For more complete information, visit

[FreePatterns.com](http://FreePatterns.com)

Copyright © 2007 DRG, 306 East Parr Road, Berne, IN 46711. All rights reserved.

This publication may not be reproduced or transmitted in part or in whole without written permission from the publisher.



*Annie's  
Attic*<sup>®</sup>

306 East Parr Road  
Berne, IN 46711

© 2007 DRG. All rights reserved.

**TOLL-FREE ORDER LINE** or to request a free catalog (800) LV-ANNIE (800) 582-6643  
**Customer Service** (800) AT-ANNIE (800) 282-6643, **Fax** (800) 882-6643  
Visit [anniesatticatalog.com](http://anniesatticatalog.com)

We have made every effort to ensure the accuracy and completeness of these instructions.  
We cannot, however, be responsible for human error, typographical mistakes or variations in individual work.  
This publication may not be reproduced in part or in whole without written permission from the publisher.

ISBN: 978-1-59635-138-7

Printed in USA

1 2 3 4 5 6 7 8 9

